

INSTALLING THE IFD SENSOR

ASSEMBLED CONFIGURATION: IFD-SENSOR-##XXX-A



PREPARE SENSOR

1 Rotate Shipping Lock counter-clockwise.

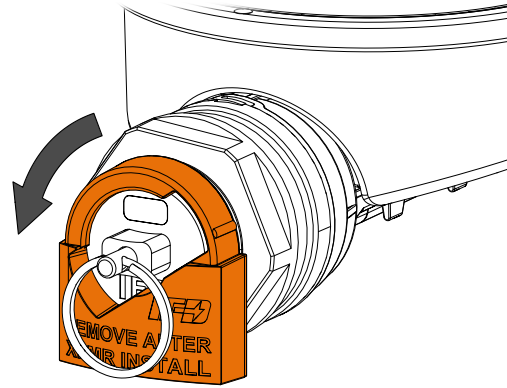

2 Remove and retain Shipping Lock.

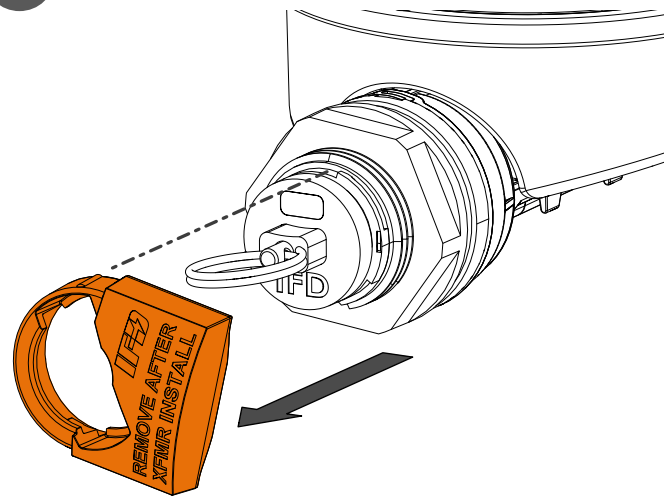

3 Remove and retain Nut.

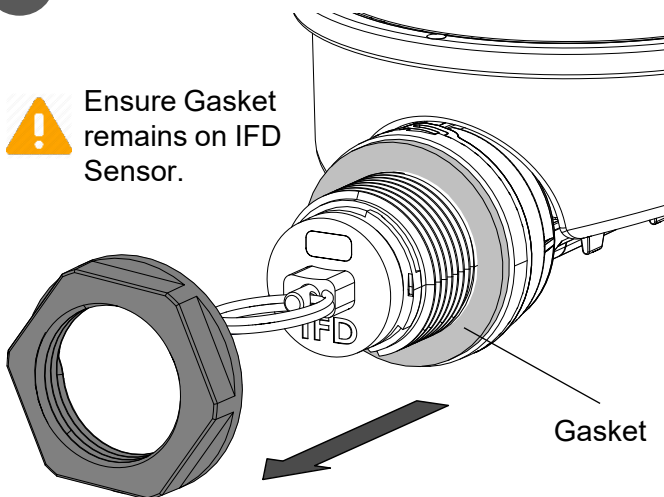

INSTALL SENSOR

4 Align keyway and insert the IFD Sensor into the mounting hole.

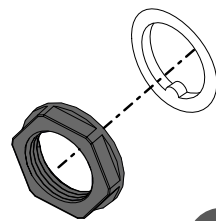
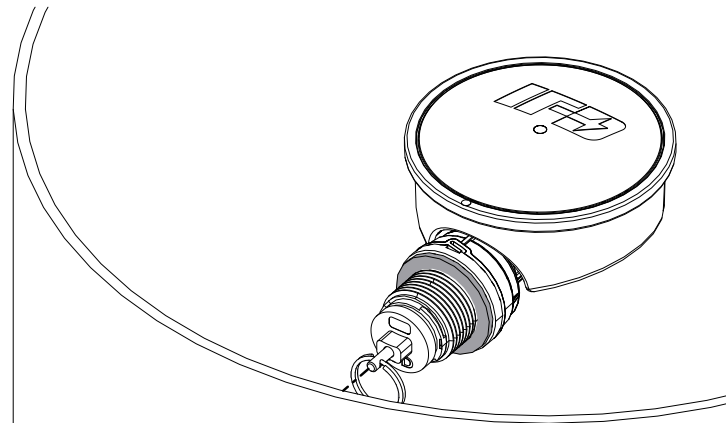

5 Install Nut until hand tight.

6 With a 42 mm socket, torque to:

- 100 ± 20 in-lb
- [11 ± 2 N-m]
- [1.15 ± 0.23 kgf-m]

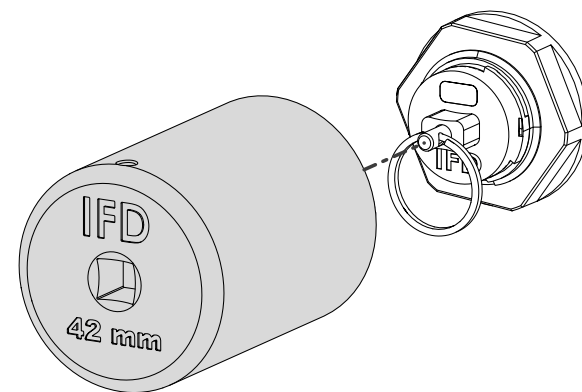

! Do not hold the IFD Sensor when applying torque to the Nut. Damage may occur.

TANK PRESSURE TESTING

! If tank pressure testing is performed through a secondary port and above the PRV venting pressure, install a PRV Plug prior to testing.

7 Align PRV Plug slot horizontally.

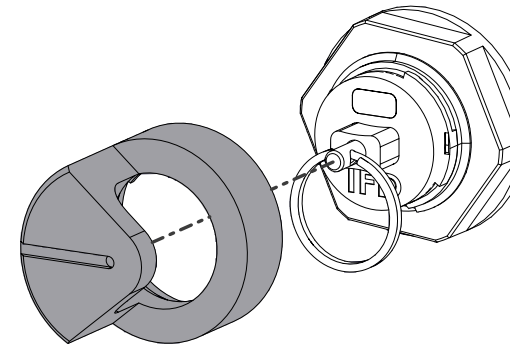

8 Push and rotate PRV Plug clockwise.

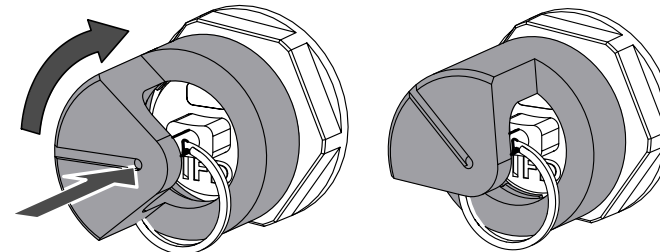

9 Conduct pressure testing.

10 Remove PRV Plug.

PREPARE FOR SHIPPING

11 Align Shipping Lock nub vertically.

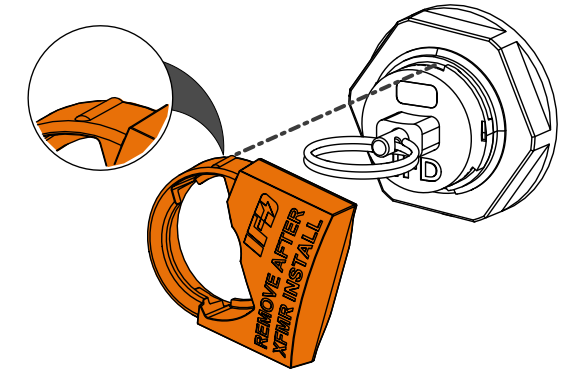

12 Push Shipping Lock and rotate clockwise to engage.

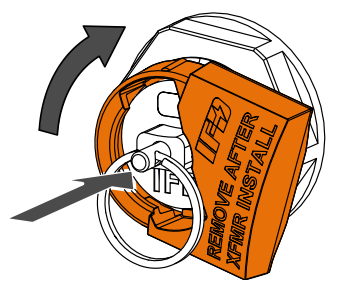

13 Install IFD Decal.

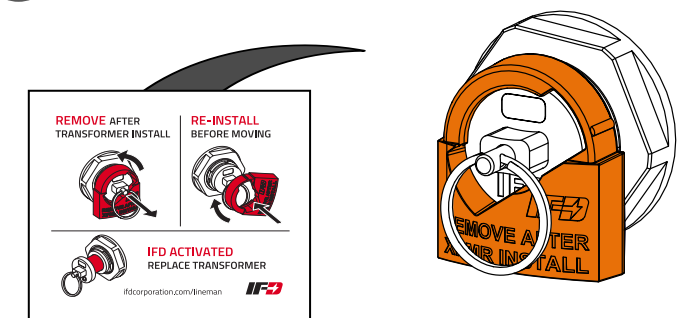

SHIPPING LOCK QUALITY CHECK

✓ Ensure that the Shipping Lock is correctly installed with **both tabs engaged**

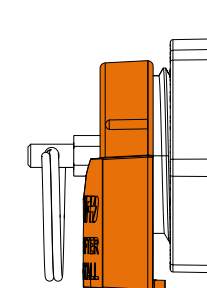

Shipping Lock installed with two tabs engaged

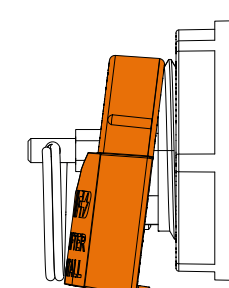

Shipping Lock installed with only one tab engaged