

PREPARE SENSOR

- 1 Rotate Temporary Shipping Lock counter-clockwise.

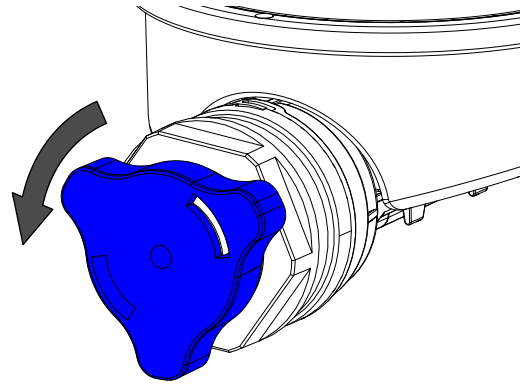

- 2 Remove and recycle Temporary Shipping Lock.

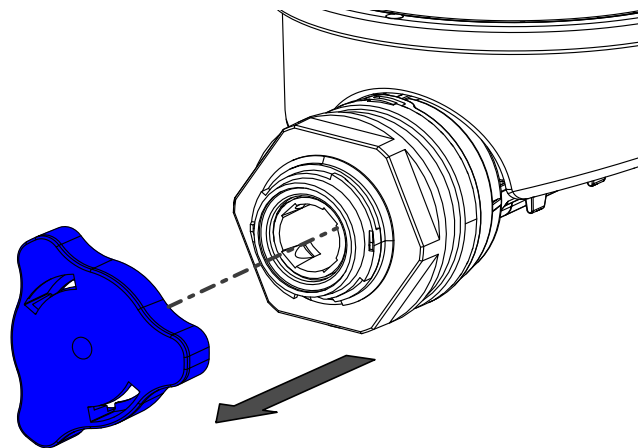

- 3 Remove and retain Nut.

Ensure Gasket remains on IFD Sensor.

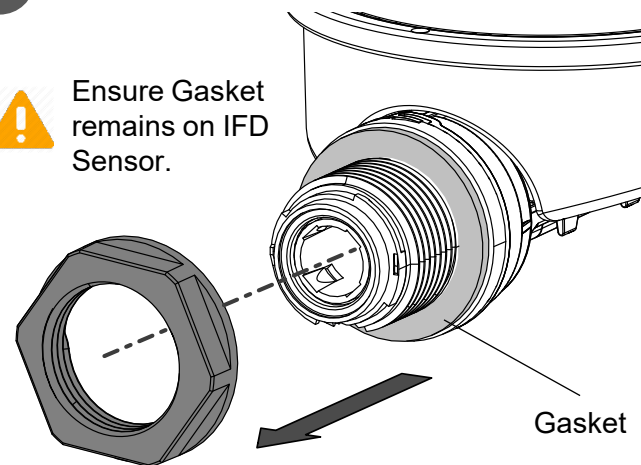

INSTALL SENSOR

- 4 Align keyway and insert the IFD Sensor into the mounting hole.

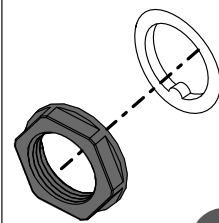
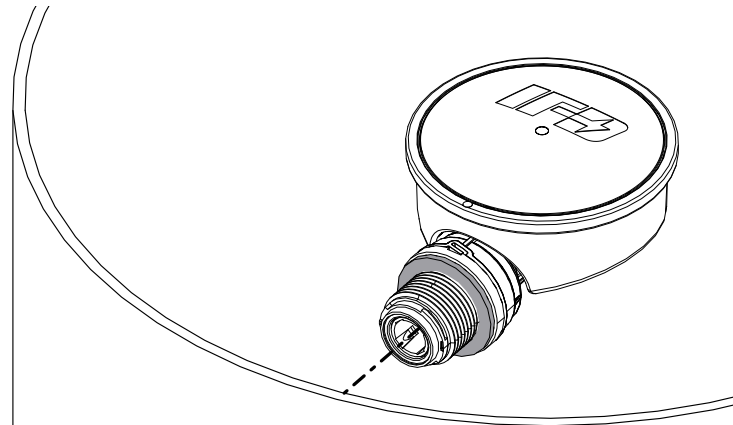

- 5 Install Nut until hand tight.

- 6 With a 42 mm socket, torque to:
 - 100 ± 20 in-lb
 - $[11 \pm 2$ N-m]
 - $[1.15 \pm 0.23$ kgf-m]

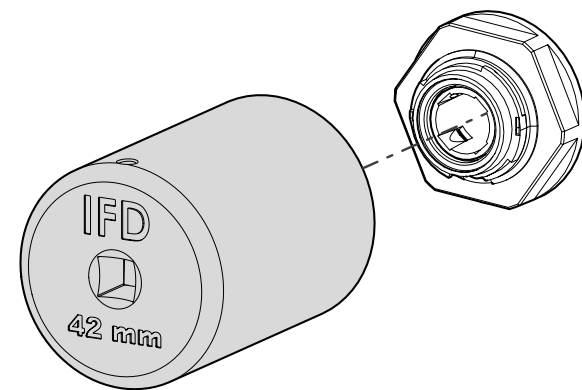

Do not hold the IFD Sensor when applying torque to the Nut. Damage may occur.

TANK PRESSURE TESTING

- 7 Insert IFD Adapter and torque to:
 - 80 ± 10 in-lb
 - $[9 \pm 1$ N-m]
 - $[0.92 \pm 0.12$ kgf-m]

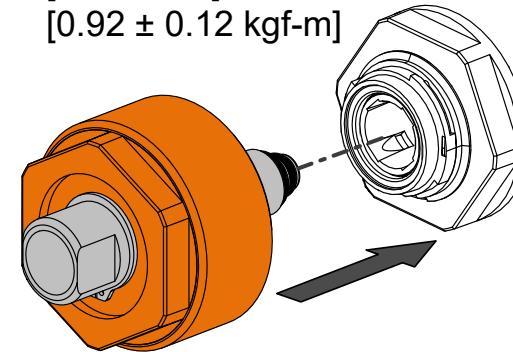

- 8 Conduct pressure testing.

- 9 Remove IFD Adapter.

- 10 Insert, then rotate PRV until snapped in.

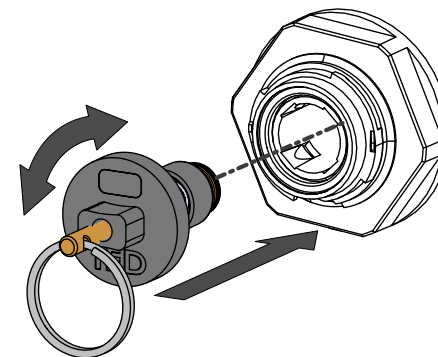

PREPARE FOR SHIPPING

- 11 Align Shipping Lock nub vertically.

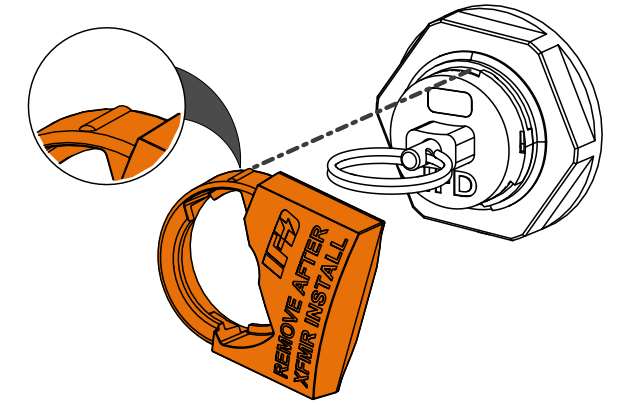

- 12 Push Shipping Lock and rotate clockwise to engage.

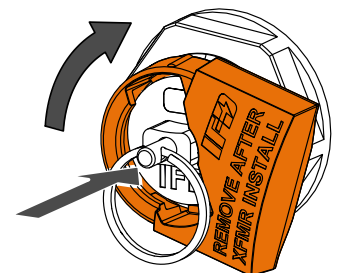

- 13 Install IFD Decal.

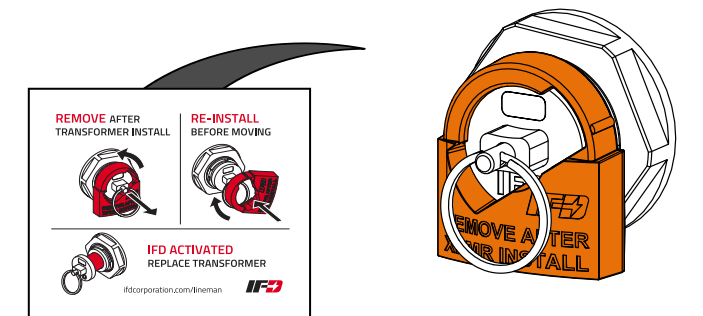

SHIPPING LOCK QUALITY CHECK



Ensure that the Shipping Lock is correctly installed with **both tabs engaged**

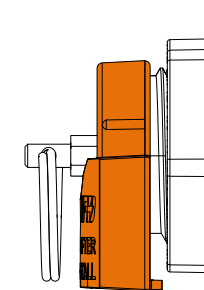

Shipping Lock installed with two tabs engaged

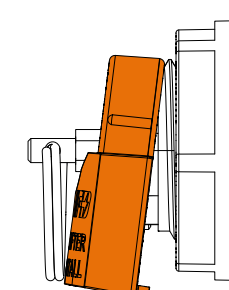

Shipping Lock installed with only one tab engaged