

# INSTALLING AND REMOVING THE SHIPPING LOCK

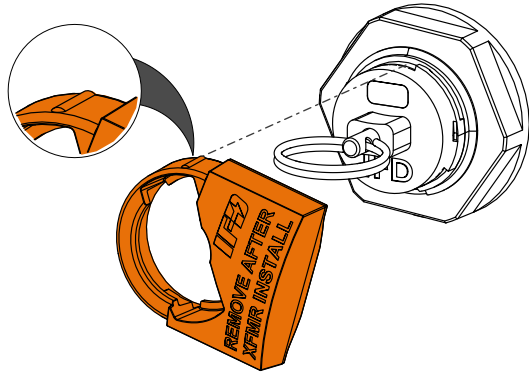

## INSTALLING THE SHIPPING LOCK

- 1 **Align** Shipping Lock nub vertically.



- 2 **Push** Shipping Lock and **rotate** clockwise to engage.

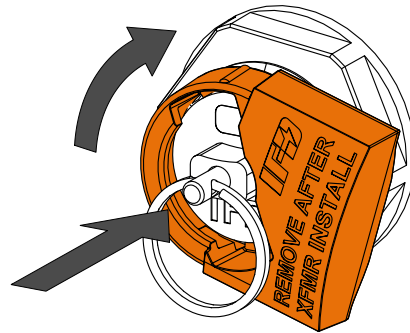

## REMOVING THE SHIPPING LOCK

- 1 **Rotate** Shipping Lock counter-clockwise.

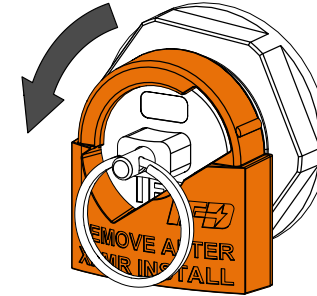

- 2 **Remove and retain** Shipping Lock.

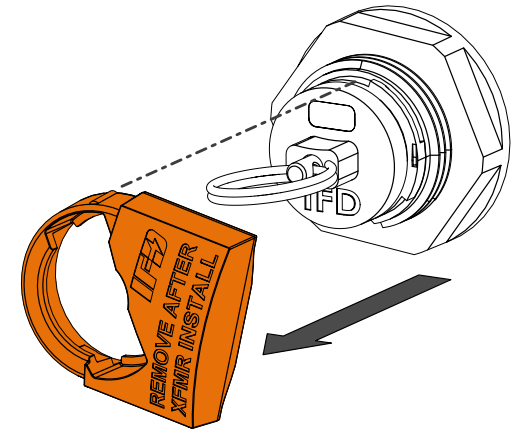

## SHIPPING LOCK INSTALLATION QUALITY CHECK

Ensure that the Shipping Lock is installed with **both tabs engaged**



An IFD Sensor will only be locked out and ready for transport if the Shipping Lock is installed correctly.

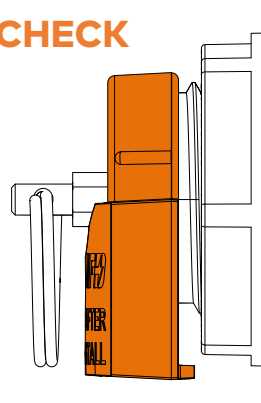

Shipping Lock installed with two tabs engaged

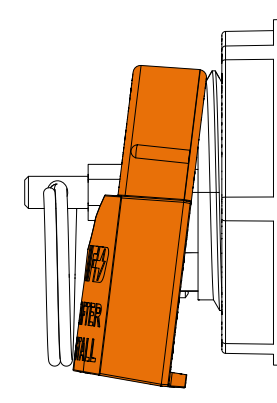

Shipping Lock installed with only one tab engaged